

Desktop Air Cooler

MANUAL

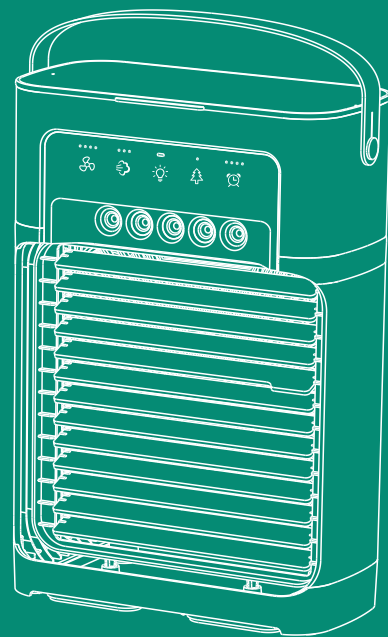

- 4 Wind Speeds
- 5 Sprays
- 7 colors LED
- Natural Wind
- 2/4/6/8H Timer

TIPS

- 1 Tap water, mineral water can be added to the water tank. Please do not add other liquids to avoid clogging the atomization piece. Because the composition of different types of water is different, the spray effect is also different. When pure water is added to the water tank, it will lead to the following 2 situations:
1. Generating more dripping water.
2. Some of the pure water conductivity is weak, resulting in this product can not accurately detect whether there is water in the tank, and thus can not be sprayed properly. For the best spraying effect, tap water or mineral water is recommended.

Tap water, mineral water can be added



- 2 Dripping water can be collected in the groove at the bottom of the product. When more water accumulates in the groove, the silicone plug can be pulled out to discharge the accumulated water.

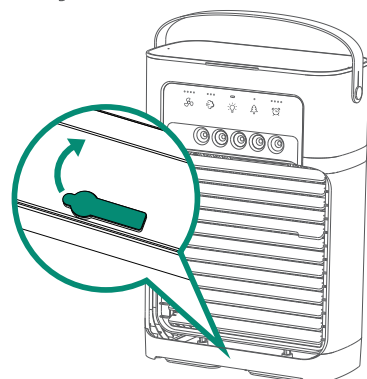

- 3 When not using the spray function, pour out the water in the water tank to prevent water leakage and bacteria growth.

- 4 There are 4 feet on the bottom of the product, which can be opened to increase the stability of the product.

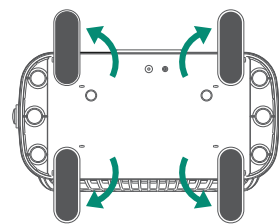

- 5 When the surface of the atomizing sheet is covered with water drops, it will cause a delay in spraying, wait for a few seconds it will spray normally.



POWER SUPPLY

The output current of the power supply equipment should be over or equal to 2A, otherwise it will cause insufficient power supply of the product and cannot work normally.

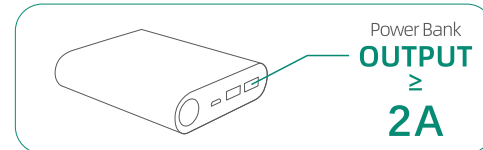
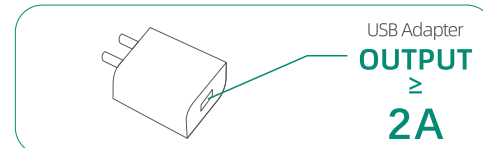
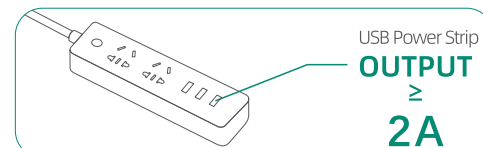

HOW TO USE

- 1 Open the water tank cover, add the right amount water, then cover it. Achieving the best spraying effect, tap water or mineral water is recommended.

Water tank capacity :
1200ml

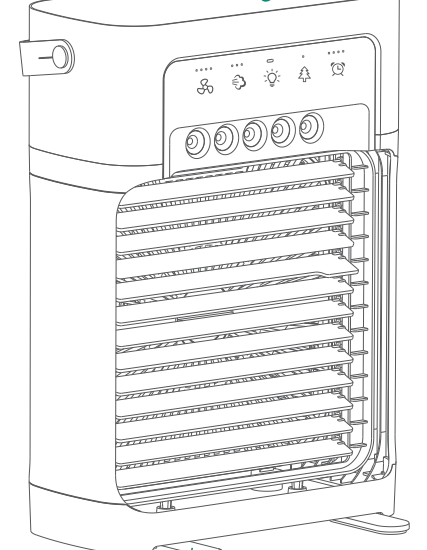
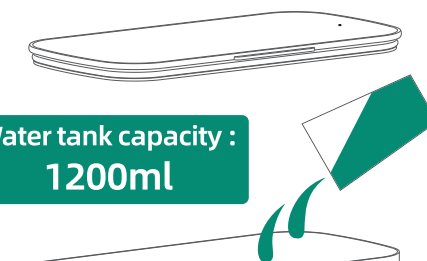

Bottom 4 feet can be opened to enhance stability.

- 2 Plug the power cord into the power supply interface to power on.



- 3 Touch the button to select the function.

- 4 Wind Speeds
- 5 Sprays
- 7 colors LED
- Natural Wind
- 2/4/6/8H Timer

- ● ● ● ● ● ● ●
- 25% 50% 75% 100%
- 4 Wind Speeds Press and hold for 2 seconds to shut down.

- ● ● ● ● ● ● ●
- 5 Sprays 1 Spray / 3 Sprays / 5 Sprays

- ● ● ● ● ● ● ●
- 7 colors LED Touch 1-7 times, switch 7 single color light. White-yellow-red-light blue-magenta-dark blue-green. Touch the 8th time, light color gradually changes. Touch the 9th time, turn off the light.

- ● ● ● ● ● ● ●
- Natural Wind First touch to turn on this function. The wind speed cycles from low to high then to low.

- ● ● ● ● ● ● ●
- Timer 2h / 4h / 6h / 8h

- 4 Adjust the appropriate wind direction.

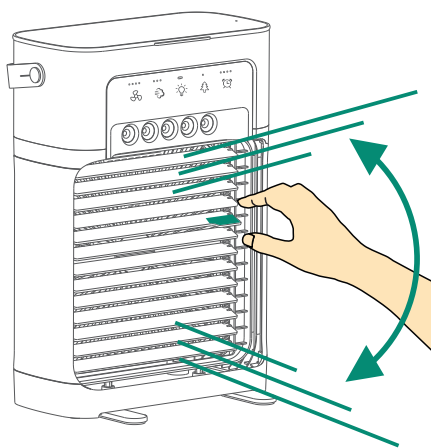

HOW TO CLEAN

- 1 First disconnect the power supply, and then open the water tank cover and wipe the water tank with a damp cloth. The cleanable design of the water tank can effectively prevent bacteria growing and protect your health.

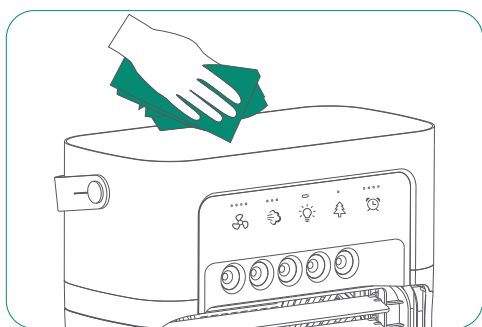

- 2 Make sure the power supply is disconnected, lift the middle part of the bottom of the air conditioning window and move it outward. Then clean it with a damp cloth or brush.

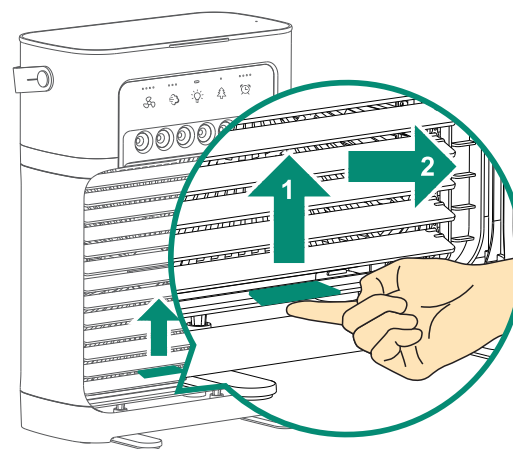

- 3 Make sure the power supply is disconnected, lift the middle part of the bottom of the fan grid and move it outward. Then clean it with a damp cloth or brush.

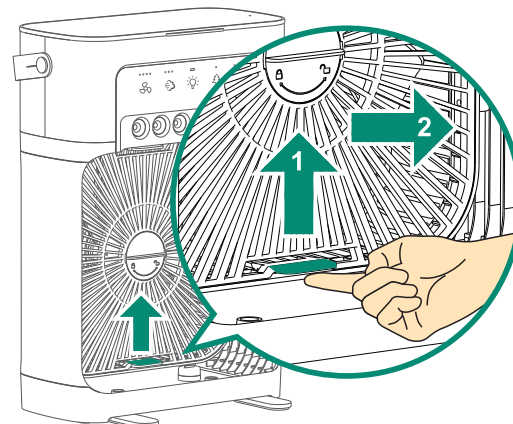

- 4 The round cap can be opened to add perfume.

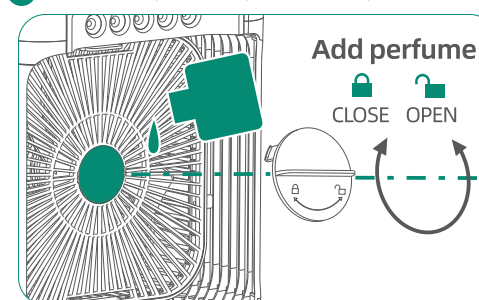

- 5 Use a damp cloth to wipe the dust on the fan blades.

PRECAUTIONS

- If you accidentally knock down the product or add water to overflow, please immediately cut off the power supply to avoid leakage. You must completely dry the power supply interface of the product before using it again.
- The product is not completely waterproof. It is forbidden to rinse or soak the entire product under water in order to avoid short-circuit and cause damage.

SPECIFICATION

Model Number	BAC-3P
Product Size	237mmx123mmx323mm
Net Weight	About 1227g
Power	10W Max
Input	5V = 2A
Interface Type	USB Type-c
Water Capacity	1200ml

