

Desktop Air Cooler MANUAL

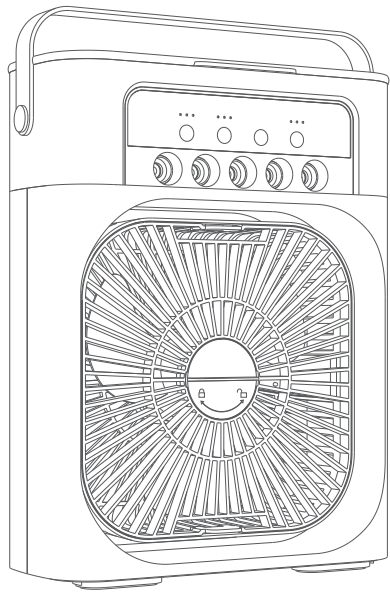

- 
Cools
- 
Humidifies
- 
7 Colors
LED
- 
1H/2H/3H
Timer

TIPS

- When the sensor detects that the amount of water in the tank is too low, it will automatically stop spraying, refill the water again, and press the spray switch to spray. Due to the weak conductivity of pure and distilled water, it will cause the spray function to not work properly. So only tap water or mineral water can be added.

ONLY ADD
tap water or mineral water

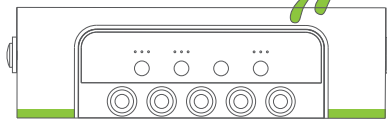

- When blowing air downwards, please do not open the spray at the same time, otherwise the fan will absorb the water mist and form water droplets, and dripping will occur on the casing.

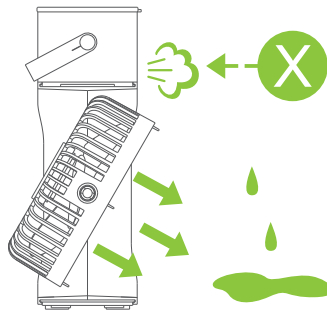

- When not using the spray function, pour out the water to prevent water leakage and bacteria growth.

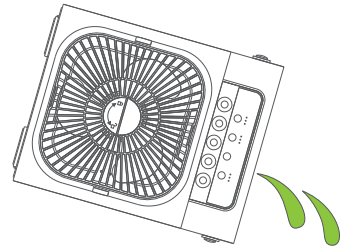

- There are 4 feet on the bottom of the product, which can be opened by rotation to increase the stability of the product.

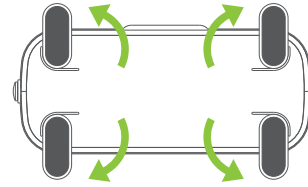

- When the surface of the atomizing sheet is covered with water drops, it will cause a delay in spraying, and wait for a few seconds to spray normally.

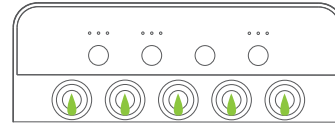

POWER SUPPLY

The output current of the power supply equipment should be over or equal to 2A, otherwise it will cause insufficient power supply of the product and cannot work normally.

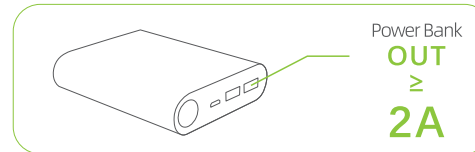
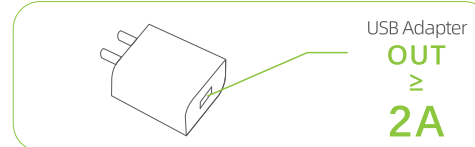
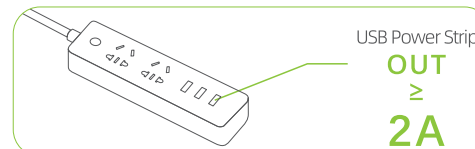

HOW TO USE

- Open the water tank cover, pour some tap water or mineral water, and then cover the water tank cover. Due to the weak conductivity of pure and distilled water, it will cause the spray function to not work properly. So only tap water or mineral water can be added.



Water tank capacity : 600ML

ONLY ADD
tap water or mineral water

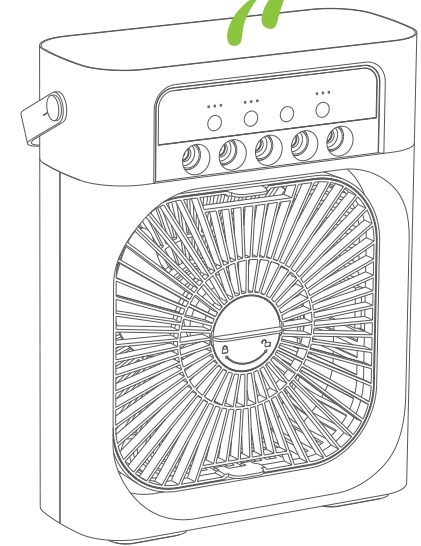

- The aromatherapy cover can be opened by rotating, the perfume is dripped on the cotton sheet, and then rotate the cover.

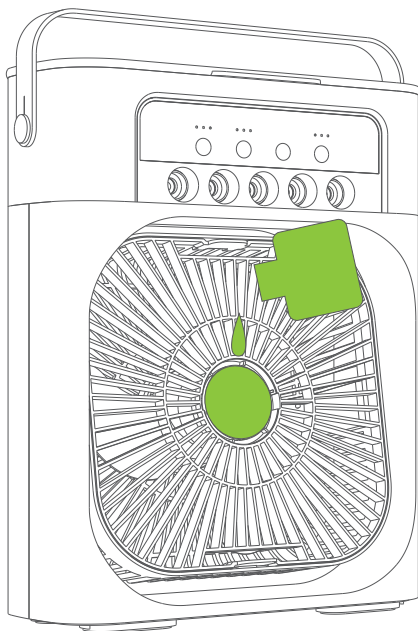
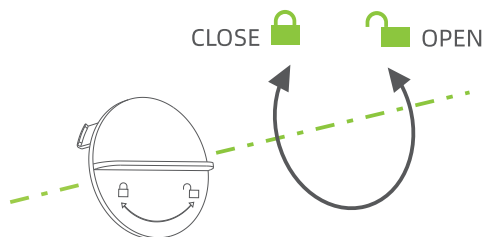

- Plug the power cord into the power supply interface for power-on.

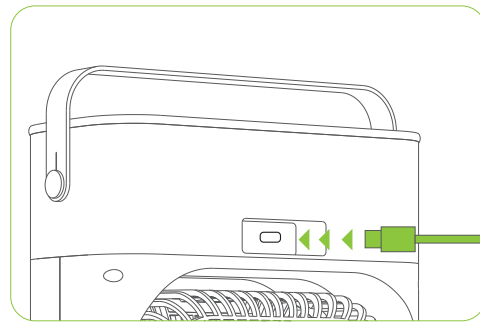

- Press the button to select the function.



 Cools: ● ●● ●●●
 Low / Medium / High

 Humidifies: ● ●● ●●●
 1pcs / 3pcs / 5pcs

 7 Colors LED: 7 Soft Colors,
 Light color changes smoothly

 Timer: ● ●● ●●●
 1H / 2H / 3H

HOW TO CLEAN

- First cut off the power supply, and then open the water tank cover and wipe the water tank with a damp cloth. The cleanable design of the water tank can effectively prevent the breeding of bacteria and protect your health.



- First cut off the power supply, and then squeeze any one of the upper and lower ends of the air outlet window toward the middle in order to remove the air outlet window, and then wipe the fan blades with a damp cloth, the air outlet window can be rinsed separately.

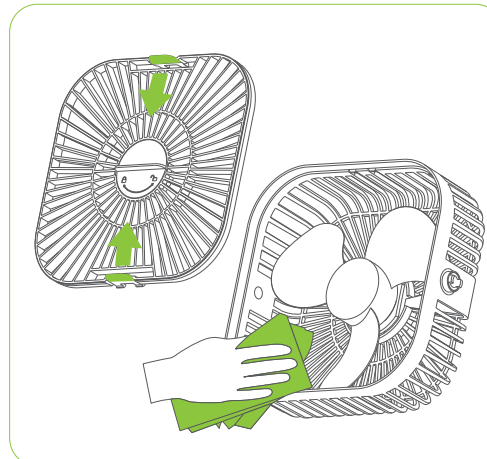

PRECAUTIONS

- Please do not tilt the product when it is working or when there is water in the water tank, it must be placed horizontally.
- Due to the weak conductivity of pure and distilled water, it will cause the spray function to not work properly. So only tap water or mineral water can be added.
- When not using the spray function, pour out the water to prevent water leakage.
- If you accidentally push down the product or add water to overflow, please immediately cut off the power supply to avoid leakage. You must completely dry the power supply interface of the product before using it again.
- Please clean the water tank and fan regularly. Cleaning method: Wipe the water tank and fan with a clean damp cloth.
- The product is not completely waterproof. It is forbidden to rinse or soak the entire product under water in order to avoid short-circuit and cause damage.

SPECIFICATION

Model Number	BAC-2P
Product Size	21cmx9cmx26cm
Net weight	About 740g
Power	10W Max
Voltage	5V
Electric current	2A Max
Blowing distance	2.5m Max
Plug	Type-C USB Plug
Max Water Filled	600ml

